

Swivel castor with total lock XDT 100



Stainless Steel Series XD - Wheel EL

-20 °C - +60 °C

+++
swivels easily

+++
wear resistant

+++
shock proof

+++
floor protective

+++
weather proof

Wheel



rubber tyre, electricallyconductive, volume resistance value $<10^4\Omega$

bolte stainless steel rim, volume resistance value $<10^4\Omega$

Fork



Finish: Polished stainless steel swivel fork AISI 304, stainless steel balls AISI 420, double ball bearing – revited, with dust protection ring, wheel axle bolted, total lock

Swivel castor with total lockWheel-Ø A x width B mm: 100x30

Load Capacity kg: 70

Load capacity tested according to EN 12530 and EN 12527

Overall height H mm: 128

Dimension of top plate TP 102x83 mm:

Hole spacing HS mm: 80x60

Hole-Ø HD mm: 9

Swivel radius SR mm: 108

Wheel bearing: Roller bearing

Advantages

- ✓ electrically conductive
- ✓ silent in motion
- ✓ good running performance
- ✓ resistant to diluted acids

©Copyright 2024 Rollenbau GmbH, www.rollenbau.at 02.06.2024

ROLLENBAU

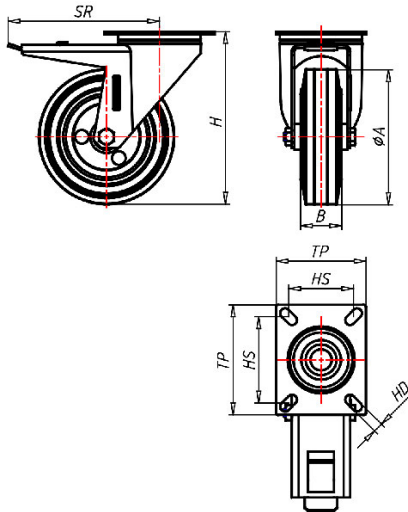

Applications

- Wet environments
- Dollies