

# Swivel castor XS 125 PSBX



Stainless Steel Series XD - Wheel PS

-30 °C - +80 °C

+++  
swivels easily

+++  
wear resistant

++  
shock proof

+++  
floor protective

+++  
weather proof

## Wheel



Cast soft polyurethane coating, 87±3 Shore A

High quality nylon wheel centre

## Fork



Finish: Polished stainless steel swivel fork AISI 304, stainless steel balls AISI 420, double ball bearing – revited, with dust protection ring, wheel axle bolted, total lock

|   |                                |
|---|--------------------------------|
| Swivel castor   | Wheel-Ø A x width B mm: 125x40 |
| Load Capacity kg:                                       | 250                            |
| Load capacity tested according to EN 12530 and EN 12527 |                                |
| Overall height H mm:                                    | 160                            |
| Dimension of top plate TP mm:                           | 102x83                         |
| Hole spacing HS mm:                                     | 80x60                          |
| Hole-Ø HD mm:   | 9                              |
| Swivel radius SR mm:                                    | 113                            |
| Wheel bearing:  | Roller bearing                 |

## Advantages

- ✓ very silent in motion
- ✓ low rolling resistance
- ✓ high abrasion and tear resistance
- ✓ high resistance to shocks
- ✓ easy to clean
- ✓ good chemical resistance

©Copyright 2024 Rollenbau GmbH, www.rollenbau.at 02.06.2024

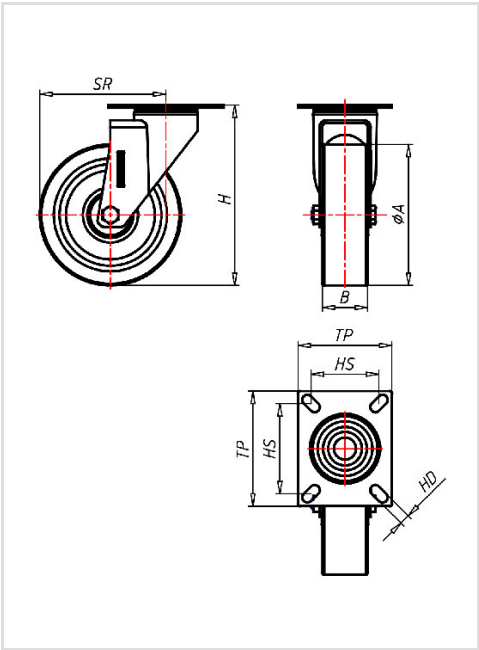

## Applications

- Kitchen equipment
- Mechatronik
- Wet environments
- Dollies