

SWIVEL CASTOR with total and directional Lock 390 SR 150 TPK

Hospital Castor Series 390 - Wheel TP

-20 °C - +80 °C

++
swivels easily

++
wear resistant

++
shock proof

++
floor protective

+++
weather proof

Wheel



Thermoplastic polyurethane tyre iron grey RAL 7011, 95 Shore A**, NON-MARKING

Core: plastic wheel centre and thread guard, silver grey RAL 7001, precision ball bearing

Fork



Finish: zinc passivated or chrome-plated, protected from dust and water ingress by plastic sealing ring or with highquality plastic cover (white RAL 9010 or metallic) suitable for disinfecting cubicle, double ball bearing in swivel head series, integrated selection mechanism with total lock or directional and total lock, continually greased



SWIVEL CASTOR with total and directional Lock Wheel-Ø A x width B mm: 150x32

Load Capacity kg: 120

Load capacity tested according to EN 12530 and EN 12527

Overall height H mm: 184

Stern mm: 27,8

Transverse bore mm: M8x19

Swivel radius SR mm: 126

Wheel bearing: Ball bearing

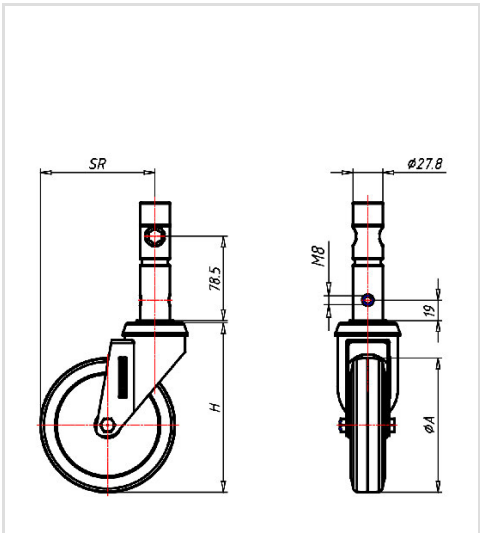

Advantages

- ✓ silent in motion
- ✓ low rolling resistance
- ✓ high abrasion and tear resistance
- ✓ high resistance to shocks
- ✓ non-marking
- ✓ good chemical resistance

©Copyright 2024 Rollenbau GmbH, www.rollenbau.at 01.06.2024

Applications

- Hospital beds