

Swivel castor 540 PT 100 PUEL

Furniture Castors Series 540 PL - Wheel PUEL

 -20 °C - +60 °C

 swivels easily

 wear resistant

 shock proof

 floor protective

 weather proof

Wheel

coated in polyurethane, 90±3 Shore Aelectrically conductive
 $<10^4\Omega$

High quality nylon wheel centre

Zinc-die-cast housing - chrome plated







Swivel bearing with combined
 plain-ball bearing

Wheel brake - glass fibre reinforced

Wheel axle revited

Swivel castor	Wheel- \varnothing A x width B mm: 100x13+13
Load Capacity kg:	70
Load capacity tested according to EN 12530 and EN 12527	
Overall height H mm:	127
Dimension of top plate TP	55x55
mm:	
Hole spacing HS mm:	42x42/40x40
Hole- \varnothing HD mm:	6,2
Swivel radius SR mm:	93
Wheel bearing:	Nylon plain bearing

Advantages

-  electrically conductive
-  silent in motion
-  low rolling resistance
-  non-marking
-  high resistance to shocks
-  good chemical resistance

©Copyright 2024 Rollenbau GmbH, www.rollenbau.at 02.06.2024

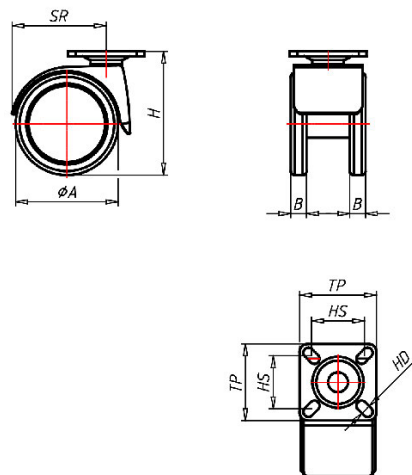
 ROLLENBAU

Applications

- Book carts
- Sidetables
- Laboratory equipment
- Instrument stands
- School furniture
- Bedside carts
- Health-Professionals