

Swivel castor 550 M10 100 PUEL

Furniture Castors Series 550 GW - Wheel PUEL

-20 °C - +60 °C

+++
swivels easily

+++
wear resistant

++
shock proof

++
floor protective

+++
weather proof

Wheel

coated in polyurethane, 90±3 Shore Aelectrically conductive
<10⁴Ω

High quality nylon wheel centre

Design-twin wheel castor, (RAL 7004) with Swivel bearing
with combined
plain-ball bearing, Lock - glass fibre reinforced, Wheel axle
revited1262
resilient PUR-tread, non- marking, wheel-/total lock Design
Zentrum Nordrhein-Westfalen Design award winner 2000
Industrie Forum Design Hannover

Swivel castor	Wheel-Ø A x width B mm: 100x20+20
Load Capacity kg:	70
Load capacity tested according to EN 12530 and EN 12527	
Overall height H mm:	119
Threat mm:	M10x15
Swivel radius SR mm:	87
Wheel bearing:	Nylon plain bearing

Advantages

- ✓ electrically conductive
- ✓ silent in motion
- ✓ low rolling resistance
- ✓ non-marking
- ✓ high resistance to shocks
- ✓ good chemical resistance

©Copyright 2024 Rollenbau GmbH, www.rollenbau.at 02.06.2024

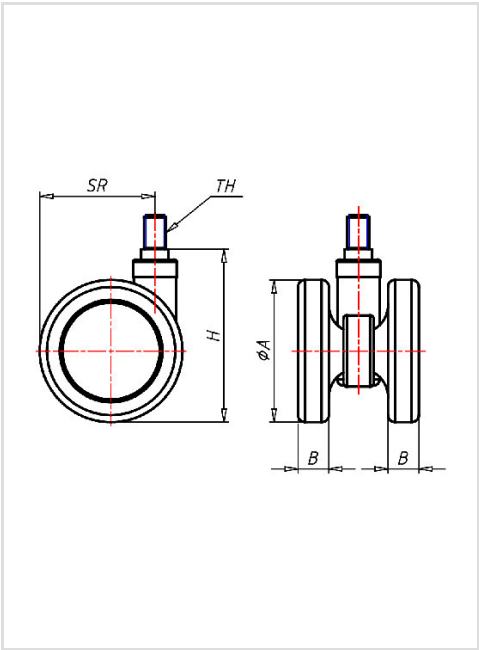

Applications

- Health-Professionals