

# Swivel castor CD 100 EB

Transport Series CD - Wheel E

-20 °C - +70 °C

++  
swivels easily

++  
wear resistant

++  
shock proof

+++  
floor protective

++  
weather proof

## Wheel



Tread: Elastic solid rubber tyre, black, 73±5 Shore A, vulcanised on wheel centre

Wheel centre: Die-cast aluminium alloy

## Fork



Finish: electro-zinc plated, double ball bearing – revited, hardened steel balls thermoplastic dust protection ring, wheel axle bolted, total lock

Swivel castor	Wheel-Ø A x width B mm: 100x40
Load Capacity kg:	120
Load capacity tested according to EN 12530 and EN 12527	
Overall height H mm:	128
Dimension of top plate TP mm:	102x83
Hole spacing HS mm:	80x60
Hole-Ø HD mm:	9
Swivel radius SR mm:	89
Wheel bearing:	Roller bearing

## Advantages

- ✓ excellent running performance
- ✓ very silent in motion
- ✓ low rolling resistance
- ✓ good abrasion resistance
- ✓ corrosion resistant
- ✓ non-marking in grey

©Copyright 2024 Rollenbau GmbH, www.rollenbau.at 21.05.2024

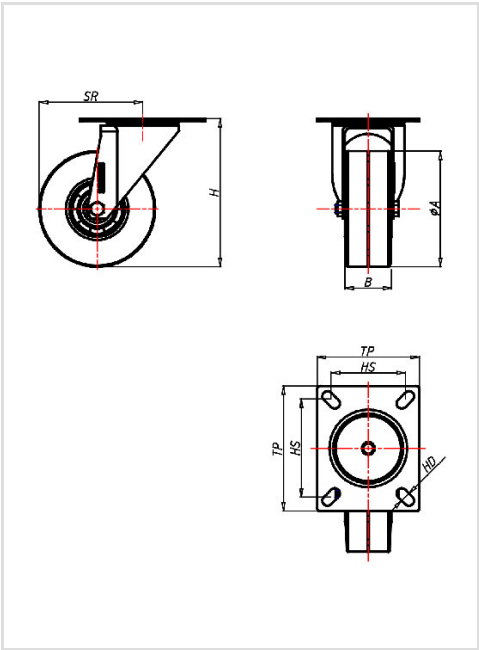

## Applications

- Bins
- Refuse bins
- Dollies
- Trash containers
- Refuse containers