

Swivel castor CSS 125 AELK

Transport Series CD - Wheel AEL

-20 °C - +70 °C

+++
swivels easily

+++
wear resistant

+++
shock proof

+++
floor protective

+++
weather proof

Wheel



coated in polyurethane, 90±3 Shore A electrically conductive
<10⁴Ω

High quality nylon wheel centre

Fork



Finish: electro-zinc plated, double ball bearing – revited,
hardened steel balls thermoplastic dust protection ring, wheel
axle bolted, total lock

Swivel castor	Wheel-Ø A x width B mm: 125x46
Load Capacity kg:	200
Load capacity tested according to EN 12530 and EN 12527	
Overall height H mm:	160
Dimension of top plate TP mm:	135x110
Hole spacing HS mm:	105x80
Hole-Ø HD mm:	11
Swivel radius SR mm:	114
Wheel bearing:	Ball bearing

Advantages

- ✓ electrically conductive
- ✓ silent in motion
- ✓ low rolling resistance
- ✓ non-marking
- ✓ high resistance to shocks
- ✓ good chemical resistance

©Copyright 2024 Rollenbau GmbH, www.rollenbau.at 23.05.2024

ROLLENBAU

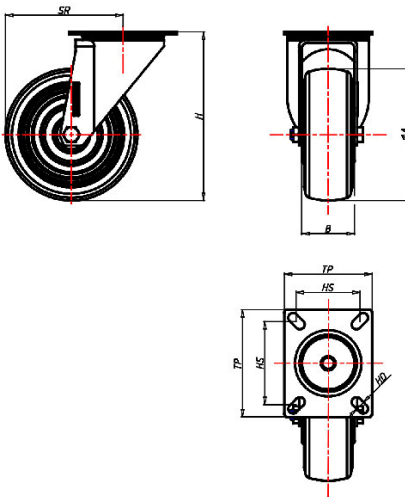

Applications

- Ingredient containers
- Dollies