

Fixed castor KDF 250 ZSK

Transport Series KD - Wheel ZS



-30 °C - +80 °C

+++
swivels easily

+++
wear resistant

+++
shock proof

+++
floor protective

+++
weather proof



Wheel



Tread: cast-polyurethane 85 +- 3 shore A soft

Wheel center: Cast-iron wheel centre - painted

Fork



Finish: electro-zinc plated, hardened steel balls, double ball race swivel head – pressed steel sheet, with strong Kingpin bolted and locked – adjustable, thermoplastic dust protection ring and seal, wheel axle bolted, adjustable total lock – leading or trailing available

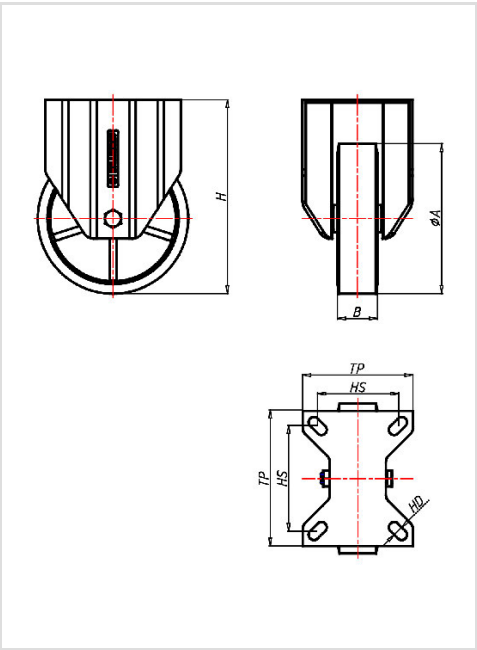

Fixed castor	Wheel-Ø A x width B mm: 250x50
Load Capacity kg:	450
Load capacity tested according to EN 12530 and EN 12527	
Overall height H mm:	304
Dimension of top plate TP mm:	135x110
Hole spacing HS mm:	105x80
Hole-Ø HD mm:	12,5
Wheel bearing:	Ball bearing

Advantages

- ✓ very silent in motion
- ✓ low rolling resistance
- ✓ high abrasion and tear resistance
- ✓ high resistance to shocks
- ✓ good chemical resistance

©Copyright 2024 Rollenbau GmbH, www.rollenbau.at 02.06.2024

Applications

- Trash container trucks
- Dollies