

Swivel castor KS 150 TLBAK

Transport Series KD - Wheel TLBA

 -20 °C - +80 °C

+++
swivels easily

+++
wear resistant

+++
shock proof

+++
floor protective

+++
weather proof

Wheel



Tread: cast polyurethane, 95 ± 2 Shore A crowned

Core: Die-cast aluminium alloy

Fork



Finish: electro-zinc plated, hardened steel balls, double ball race swivel head – pressed steel sheet, with strong Kingpin bolted and locked – adjustable, thermoplastic dust protection ring and seal, wheel axle bolted, adjustable total lock – leading or trailing available

Swivel castor	Wheel-Ø A x width B mm: 150X50
Load Capacity kg:	400
Load capacity tested according to EN 12530 and EN 12527	
Overall height H mm:	207
Dimension of top plate TP mm:	135x110
Hole spacing HS mm:	105x80
Hole-Ø HD mm:	12,5
Swivel radius SR mm:	127
Wheel bearing:	Ball bearing

Advantages

- ✓ ergonomic running with crowned tread
- ✓ very silent in motion
- ✓ very low rolling resistance
- ✓ easy in revving
- ✓ high abrasion and tear resistance
- ✓ good chemical resistance

©Copyright 2024 Rollenbau GmbH, www.rollenbau.at 02.06.2024

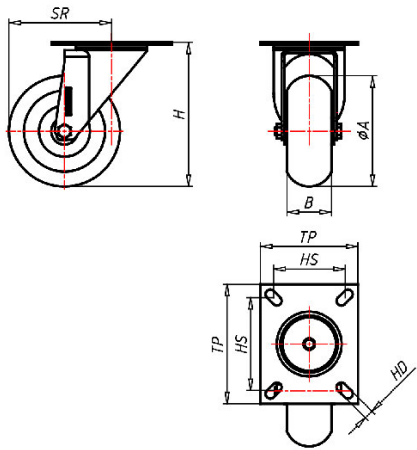

Applications

- Metal-Technology
- Trash container trucks
- Workshops
- Dye trucks
- Dollies
- Carpentry
- Building-Industry