

Swivel castor LR315 50 TPK

Spring-loaded Castors Series LR - Wheel TP

-20 °C - +60 °C

++
swivels easily

++
wear resistant

+
shock proof

+++
floor protective

++
weather proof

Wheel



Tread: Thermoplastic elastomer coating 95±3 Shore A**

High quality nylon wheel centre

Fork



Finish: zinc plated and chromate coated, large double ball bearing - Ø 46 mm, revited, dust protection ring, wheel axle bolted and locked, wheel-/total lock - spring stainless steel

Swivel castor	Wheel-Ø A x width B mm: 50x18
Load Capacity kg:	50
Load capacity tested according to EN 12530 and EN 12527	
Overall height H mm:	150
Dimension of top plate TP mm:	59,5x48
Hole spacing HS mm:	38x22,5
Hole-Ø HD mm:	5,3
Swivel radius SR mm:	53
Wheel bearing:	Ball bearing

Advantages

- ✓ silent in motion
- ✓ low rolling resistance
- ✓ high resistance to shocks
- ✓ non-marking
- ✓ easy to clean
- ✓ good chemical resistance

©Copyright 2024 Rollenbau GmbH, www.rollenbau.at 02.06.2024

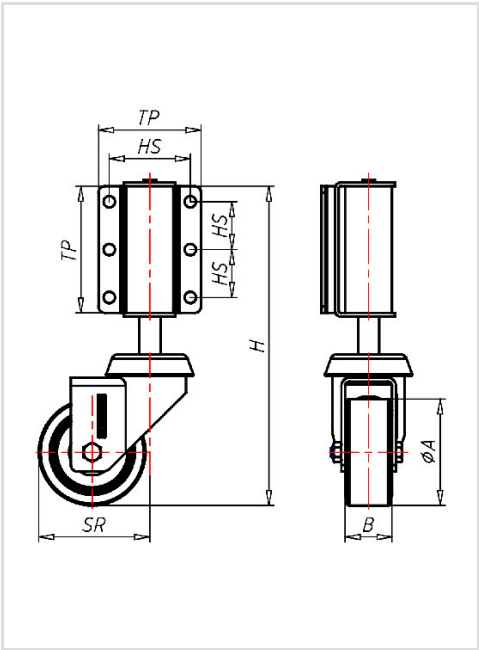

Applications

- Decoration carts
- Metal-Technology
- Stage equipment
- Carpentry
- Building-Industry