

Wheel 125 PBX 20

Forklift wheels Series P

 -20 °C - +80 °C

++●

swivels easily

+++

wear resistant

+++

shock proof

++●

floor protective

+++

weather proof



Wheel

Casted high quality nylon wheel

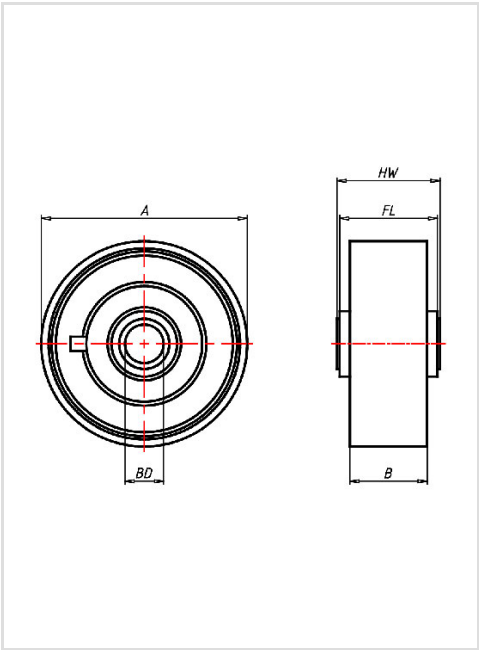

Wheel	Wheel-Ø A x width B mm: 125x40
Load Capacity kg:	300
Load capacity tested according to EN 12530 and EN 12527	
Hub width mm:	50
Fixing length mm:	50
Wheel bearing:	Stainless steel roller bearing
Bore diameter mm:	20

Advantages

- ✓ easy running on smooth floors
- ✓ impact proof
- ✓ high abrasion resistance
- ✓ easy to clean
- ✓ high chemical resistance

Applications

- Meat processing vats