

Wheel 100 PSB 15

Wheels Series PS

 -30 °C - +80 °C

swivels easily

wear resistant

shock proof

floor protective

weather proof

Wheel

Cast soft polyurethane coating, 87±3 Shore A

High quality nylon wheel centre

Wheel	Wheel-Ø A x width B mm: 100x40
Load Capacity kg:	250
Load capacity tested according to EN 12530 and EN 12527	
Band thickness mm:	10
Hub width mm:	40
Fixing length mm:	40
Wheel bearing:	Roller bearing
Bore diameter mm:	15

Advantages

- ✓ very silent in motion
- ✓ low rolling resistance
- ✓ high abrasion and tear resistance
- ✓ high resistance to shocks
- ✓ easy to clean
- ✓ good chemical resistance

©Copyright 2024 Rollenbau GmbH, www.rollenbau.at 02.06.2024

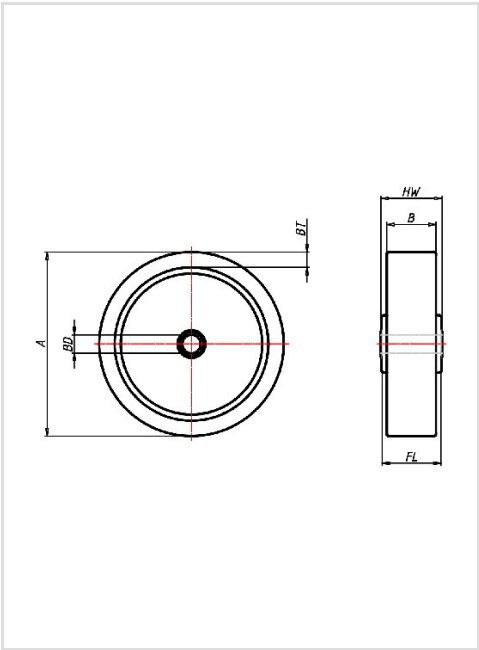

Applications

- Fork-lifts