

Rail Wheel 250 SP-40

Rail wheels Series SP

-40 °C - +300 °C*

++
swivels easily

+++
wear resistant

+++
shock proof

++
floor protective

++
weather proof

Wheel

Cast-iron single-flanged wheeltread properly machined, 3° tread anglefinish: painted

ROLLENBAU

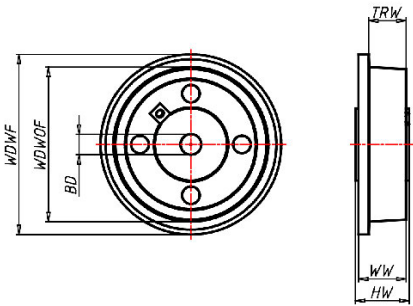
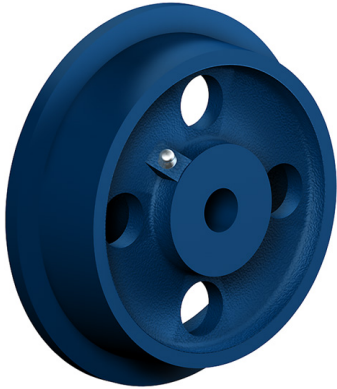

Rail Wheel

Wheel-Ø without flange mm:250

Wheel-Ø with flange mm: 300

Tread width mm: 50

Wheel width mm: 65

Load Capacity kg: 2000

Load capacity tested according to EN 12530 and EN 12527

Hub width mm: 70

Wheel bearing: Plain bearing

Bore diameter mm: 40

Advantages

- ✓ very high load capacity
- ✓ excellent abrasion resistance
- ✓ for high temperatures

©Copyright 2024 Rollenbau GmbH, www.rollenbau.at 02.06.2024

Applications

- Building-Industry