

Rail Wheel 30 SPA-10

Rail wheels Series SPA

 -30 °C - +80 °C

swivels easily

wear resistant

shock proof

floor protective

weather proof

Wheel

Single flanged wheel - high quality nylon tread properly machined running surface with a 3° gradient

Rail Wheel

Wheel-Ø without flange mm: 30

Wheel-Ø with flange mm: 50

Tread width mm: 15

Wheel width mm: 20

Load Capacity kg: 35

Load capacity tested according to EN 12530 and EN 12527

Hub width mm: 20

Wheel bearing: Plain bearing

Bore diameter mm: 10

Advantages

- ✓ low rolling resistance
- ✓ high abrasion resistance

©Copyright 2024 Rollenbau GmbH, www.rollenbau.at 03.06.2024

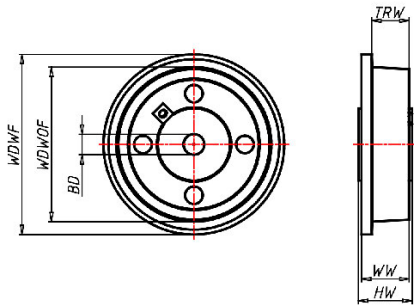
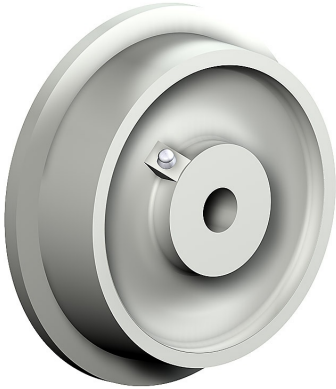

Applications

- Building-Industry