

Rail Wheel 150 SPEK 30

Rail wheels Series SPE

 -30 °C - +80 °C

++●

swivels easily

+++

wear resistant

+++

shock proof

++●

floor protective

++●

weather proof

Wheel

Single flanged wheel made of high-compressedsemi rigid cast nylon, made of solid material turnedrunning surface with a 3° gradient

Rail Wheel	
Wheel-Ø without flange mm:	150
Wheel-Ø with flange mm:	175
Tread width mm:	38
Wheel width mm:	52
Load Capacity kg:	950
Load capacity tested according to EN 12530 and EN 12527	
Hub width mm:	52
Wheel bearing:	2 Ball bearings ZZ
Bore diameter mm:	30

Advantages

- ✔ low rolling resistance
- ✔ high abrasion resistance
- ✔ very high load capacity

©Copyright 2024 Rollenbau GmbH, www.rollenbau.at 02.06.2024

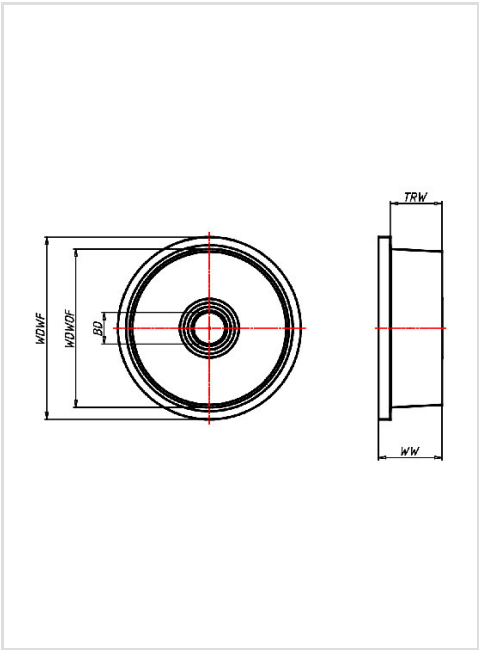

Applications

- Building-Industry